

## ESSMANN® Fresh Air Systems for Smoke and Heat Extraction Systems

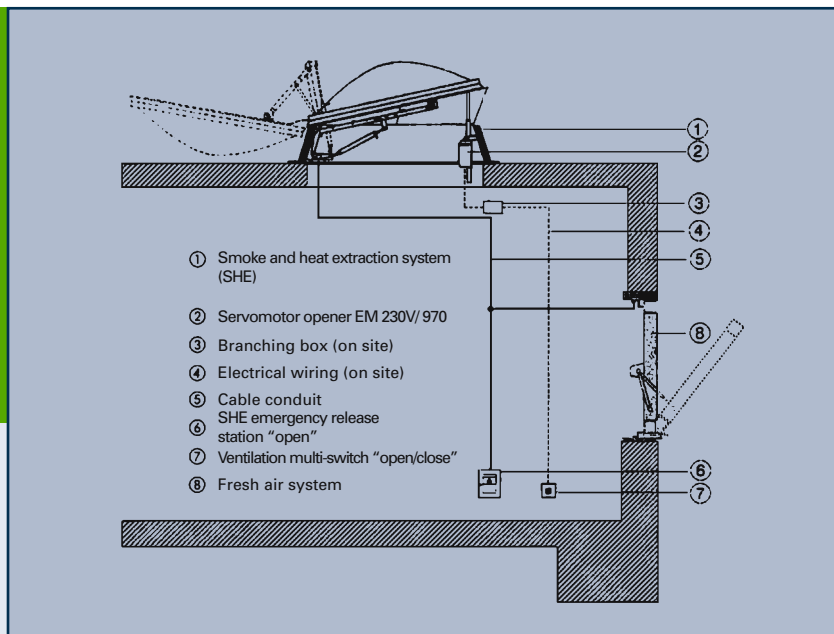

## Product Description

ESSMANN® Fresh Air Systems  
for Smoke and Heat Extraction Systems



ESSMANN fresh air flap combined with ESSMANN SHE for skylight domes type F-6



ESSMANN fresh air flaps

ESSMANN fresh air systems for smoke and heat extraction systems (SHE) provide fresh air openings in the outer walls of buildings to ensure full aerodynamic effectiveness of the smoke and heat extraction systems. ESSMANN fresh air flaps comprise an installation frame that is mounted on an opening in the building. The lower edge of the flap is hinged to the installation frame.

ESSMANN fresh air systems are opened manually from a secure position or when the installed SHE system is activated. ESSMANN fresh air flaps for SHEs are available in 3 bare shell dimensions up to a max. width of 1.96 m and a max. height of 2.10 m with a non-profiled surface on

the outer wall. Cladding using local profiles can then be added on site to enhance the compact architectural integration into the exterior shell of the building. The flap opens vertically to an angle of approx. 38 or 60°. If the lower pivotal point of the fresh air flap is less than 2.50 m above the floor, a safety area of 2 x 2 m must be ensured and marked around the flap.

**ESSMANN finned ventilators** can alternatively also be integrated into the facade of a building to provide the fresh air needed to optimise the functionality of a SHE system.

### Available fresh air flap sizes

Bare opening dimensions W x H in cm	Fresh air face in m <sup>2</sup>	Opening angle
196 x 110	0,64	38°
196 x 160	0,94	33°
196 x 210	1,23	28°



Further information can be found at [www.essmann.de](http://www.essmann.de)

ESSMANN GmbH  
Im Weingarten 2  
D-32107 Bad Salzufflen  
Telephone +49 (0)5222.791-0  
Telefax +49 (0)5222.791-236  
E-Mail [info@essmann.de](mailto:info@essmann.de)  
[www.essmann.de](http://www.essmann.de)

A member of the **ESSMANN GROUP**.