

**A look under ESSMANN's roof.
And behind their facade.**

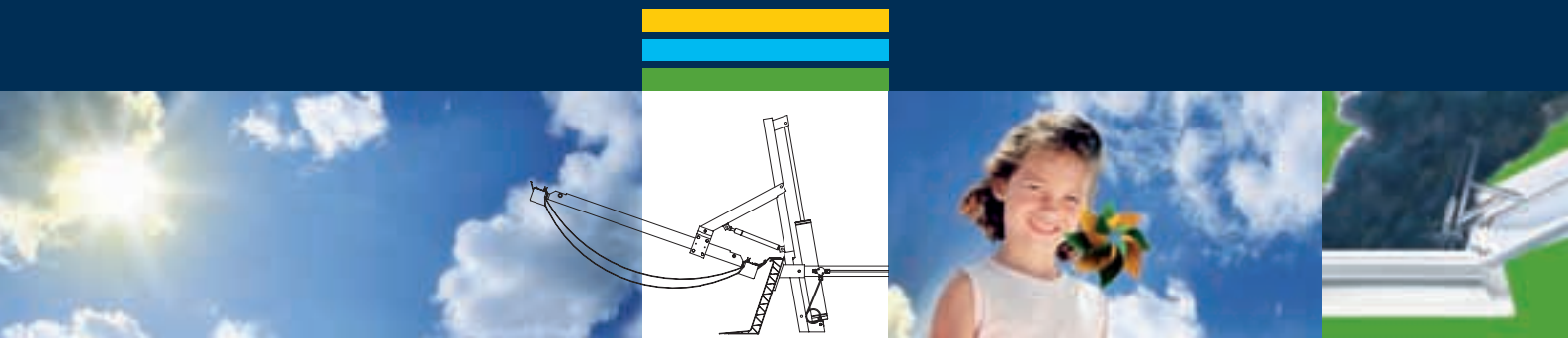

ESSMANN
GROUP



Contents

Foreword 3

A warm welcome...

Protection and safety. 4

From the flat roof to the system roof.

Aesthetics and function. 6

The facade – not just a pretty face.

The idea behind ESSMANN. 8

Innovation out of tradition.

Strong within the group. 10

A network of specialists.

More daylight – more wellbeing. 12

The power is in the sun.

More air – more satisfaction. 14

The best air conditioning is none at all.

More protection – more safety. 16

Fire and smoke protection system.

More performance – more trust. 18

Experts and partners in all aspects of flat roofs.

The people in the ESSMANN GROUP. 20

Capital and potential.

Service in the ESSMANN GROUP. 21

We take care.

The future of the ESSMANN GROUP. 22

We are ready.



Imprint

Editors:

ESSMANN GmbH Bad Salzuflen,
STG-BEIKIRCH Industrieelektronik +
Sicherheitstechnik GmbH & Co. KG
Lemgo-Lieme

Photos & illustrations:

ESSMANN GROUP, Corbis, Getty Images

Conception & realization:

Graphic Group Bielefeld

The ESSMANN GROUP – at home on the flat roofs of Europe.



 Production and distribution location

 Distribution location

 Partners

More than 100 field representatives

More than 200 trading partners all over Europe

A warm welcome ...



... to customers of the professionals for flat roofs and facades.

For more light, fresh air and safety in and on buildings. For architects, roofers, specialist roofing dealers, property developers and general contractors.

We are publishing this brochure for you so that you can get to know us better. Those of you who already know us will still discover a few new facts about ESSMANN, not to mention those of you who do not.

Allow us to bring you a little bit closer to the ESSMANN GROUP with its network of companies: ESSMANN, STG-BEIKIRCH, ECODIS, MSG, EURO SISTEMA INCENDIO (E.S.I.) and SEP Moravia. Each of these companies specializes in a particular area and everything is backed up

by more than 60 years of experience – our structure, our way of thinking, our work method and our offer for economic cooperation as a partner!

And of course we would also like to show you all the things we have done, or rather built, because that is our incentive: to offer you the best possible development, planning, consulting, technical implementation and service. We have the right solution for safe utilization in commercial, administration and industrial buildings.

Take a bit of time and allow us to convince you. The ESSMANN GROUP team is looking forward to receiving your questions and listening to your problems. We will find the ideal solution by working together. That's a promise.

Your ESSMANN GROUP Team

ESSMANN
GROUP



Protection and safety.

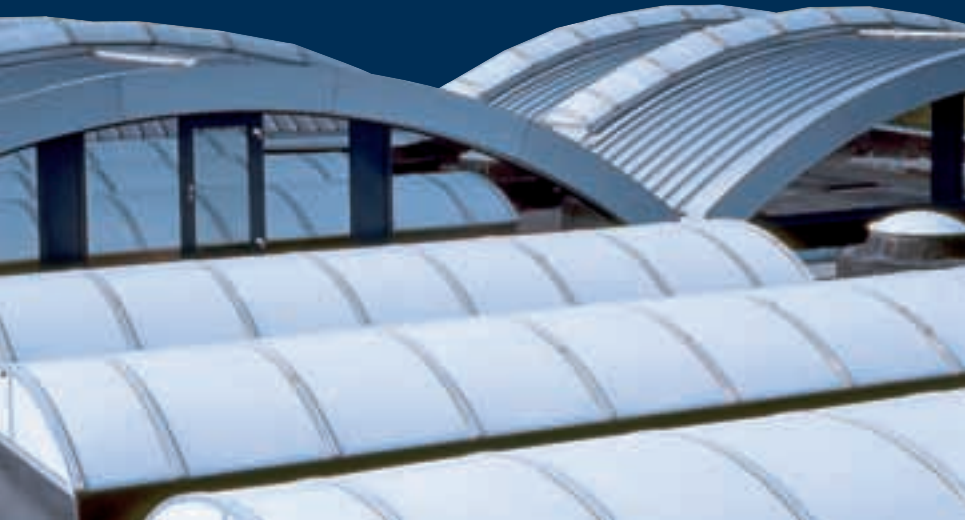

From the flat roof to the system roof.

Nothing characterizes the image of a town more than the facades of its buildings. Entire streets present themselves with a more or less uniform appearance.

You get a completely different impression, however, when you take a bird's eye view of the same streets, where many different roof shapes and sizes set the accents like a crown on a head: steeply sloping, inclined in many different graduations or simply flat. Each and every one with its own special design and utilization options. Each and every one with its own level of protection and safety for humans and goods.

The flat roof can look back on a long history. Its origins are to be found in ancient times. In addition to its special construction, advantages, such as optimum space utilization, the economical use of materials and the fulfilment of aesthetic requirements, the modern flat roof has much more to offer nowadays. Important functional elements for optimized lighting, airing and ventilation and precise smoke extraction in the event of fire are shifting the flat roof more and more to the centre of modern architectural solutions.

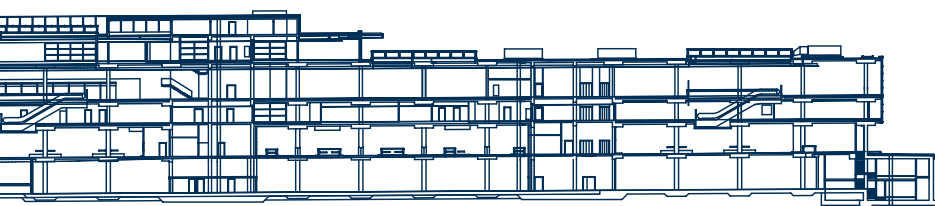

Intelligent solutions are needed here in order to influence and control existing external conditions in such a way that the highest possible level of comfort and convenience is achieved for the building users on the inside. Light, air and safety make up the central components here.

Light means lighting under special consideration of daylight utilization with a simultaneous reduction of artificial lighting requirements.

Air means natural ventilation to improve the air in the room supported by the use of mechanical airing and ventilation systems, depending on requirements.

Safety means fire protection as a precautionary concept and/or measure to decisively counteract the spread of heat and above all smoke.

Because it is so well-conceived, the flat roof satisfies the highest demands on comfort, economy and safety in commercial and industrial buildings, storage warehouses and production plants.



"Everything simply runs more smoothly when you have the right partner. Experience pays off in the end!"

Graduate Engineer Erwin Kugelmann, Kocher Regalbau, Stuttgart

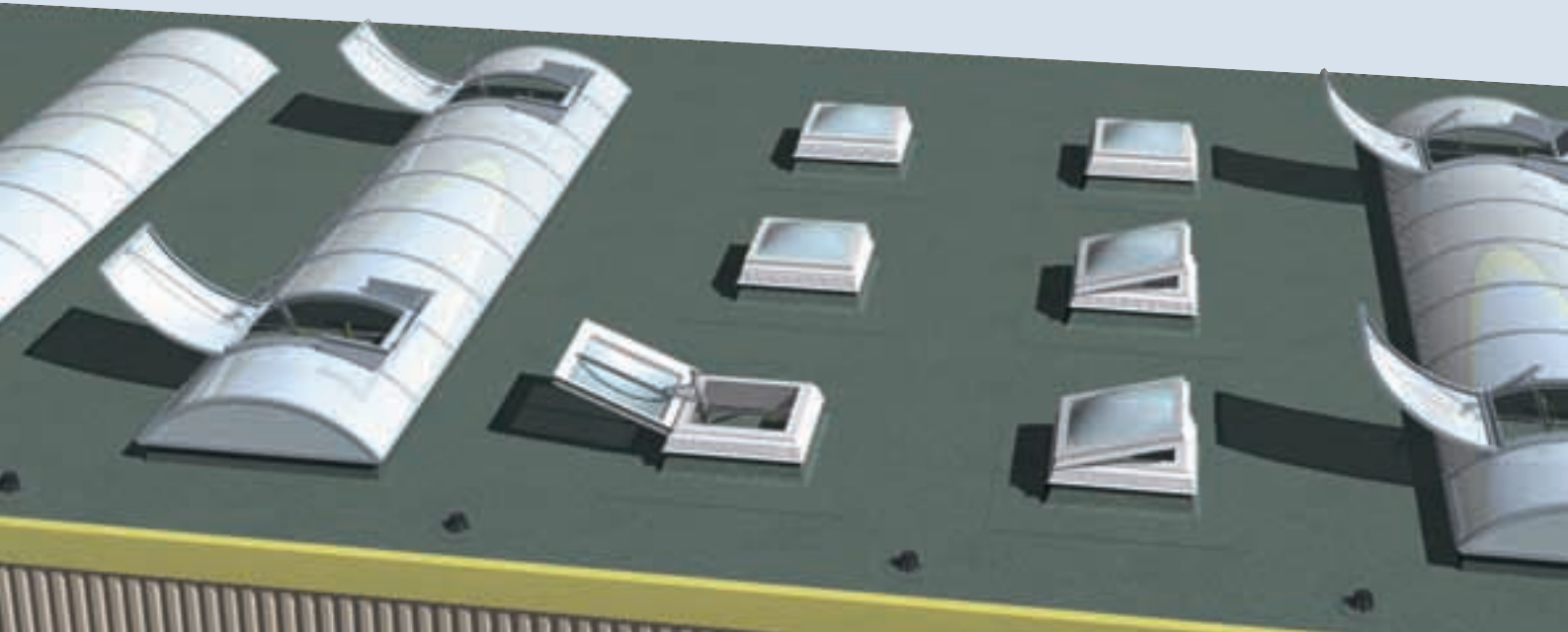

Aesthetics and function.



The facade – not just a pretty face.

Apart from all the different versions of the roof construction, special demands are also placed on the facade of a building. The facade not only serves as protection against the weather; safety and economy are just as much the focus of attention as the aesthetic, and therefore cultural function.

In recent years, a further important aspect has been added to the shell of the building over and above its design significance. Research and development people are working intensively on giving facades a variety of vital functions.

With a combination of flat roof and facade solutions, the ESSMANN GROUP is relying on sound concepts to tangibly reduce the energy consumption of a building, for example, while enhancing the quality of living and working conditions at the same time.



"On the construction site, you need partners who can react quickly and competently. ESSMANN is one of them."

Graduate Engineer Robert Wiehofsky, Architects' and Engineers' Office Podufal + Wiehofsky, Lüne



The idea behind ESSMANN.



Innovation out of tradition.

More than 60 years ago Heinz Essmann began writing the success story of the ESSMANN GROUP. While the company focused on the sale of chipboard for roof insulation to begin with, this soon was not enough to satisfy the ambitions of the far-sighted company founder. He saw the future in specializing to satisfy the needs of flat roof and facade technology, and he created the prerequisites which have made ESSMANN one of the leading providers in Europe today.

This is an obligation and an incentive at the same time: in close cooperation with architects, roofers, specialized roofing materials dealers, property developers and general contractors, our engineers and developers work constantly to produce improvements and market-dominating innovations for the product lines "Light, Air and Safety for Commercial, Industrial and Administration Buildings". All of this is done on the basis of profound knowledge of the market and the willingness to face up to every challenge by finding the optimum solution. The large number of employees who work in customer service on-site (there is currently a field service staff of over 70) also contributes to the desired success, because this guarantees proximity and an open ear for the requirements of a discerning group of users.

ESSMANN
GROUP



ESSMANN GmbH has been strengthened in the past by selective and specific mergers with companies that bring with them additional know-how which enhances our knowledge in the field of flat roofs and facades. And as an advantage for our customers and partners. To be able to increasingly be able to deliver one-stop-shop solutions, strong "soloists" such as, for example, STG-BEIKIRCH with its registered office in Lemgo and MSG in Detmold are members of the ESSMANN GROUP as are the French company ECODIS and the Spanish company EURO SISTEMA INCENDIO (E.S.I.) which act as a mainstay for the whole southern European region. The production for the East European market occurs by the czech company SEP Moravia.

Marketing locations in Poland, Hungary, Spain and Russia and partner agencies in several countries all the way across to the United Arab Emirates ensure that we are always kept busy with new and interesting tasks.

We regard our commitment in many associations and work groups, along with certification in accordance with DIN EN ISO 9001 and DIN EN ISO 14001, and the 2005 Trade Association Promotion Prize "Innovation in Prevention" – only one of many awards – as recognition of our work.



Strong within the group.



A network of specialists.

Finding the right single source solution for the desired application is something the ESSMANN GROUP does every day in life. Consistently and skilfully. The individual companies that ensure this success are as follows:

From its headquarters in Bad Salzflen, ESSMANN GmbH develops, plans and produces lighting, airing, ventilating and smoke extraction systems for the flat roofs and facades of buildings of all kinds. This is supplemented by systems for selective drainage.

“Made in Germany” isn’t just a catch phrase here, it’s a clearly defined corporate objective and quality promise. What began with skylight domes and arcade rooflights has developed in the course of time into a technically sophisticated system range which can be deployed extremely efficiently to either save energy, improve the air in rooms or enhance safety, depending on requirement or legal provisions.

In a similar business sector, ECODIS S.A.S, with headquarters in Lyon, met the challenges provided by the South European market in cooperation with EURO SISTEMA INCENDIO (E.S.I.) in Spain as well as SEP Moravia the East European market in Czech Republic. MSG GmbH & Co. KG is a member of the ESSMANN GROUP and ranked as a reliable specialist for the professional assembly, maintenance and service of illumination, aeration and ventilation as well as smoke extraction systems. Regional locations throughout the country and in bordering countries create an area-wide assembly and service network and also offer direct on-site service for customers.



STG-BEIKIRCH Industrieelektronik + Sicherheitstechnik GmbH & Co. KG is another system partner active within the ESSMANN GROUP. The company develops, projects and produces electronic devices for the entire field of smoke and heat extraction systems and ventilation technology. From safety drives to complex, decentralized LON-BUS network technology. The company has made a name for itself with systems for natural smoke extraction, airing and ventilation produced in consistently high quality. In the corporate area of industrial electronics, STG-BEIKIRCH produces electronic components for its own products as well as those of other companies inside and outside the ESSMANN GROUP.

The range of performances extends from development to production and from the layout to the tested printed circuit. Flexible in prototype and series production, the electronic components can be manufactured using conventional and SMD technology.

Committed professionals are designing challenging solutions which guarantee safety at the highest level in the Lemgo-Lieme works.

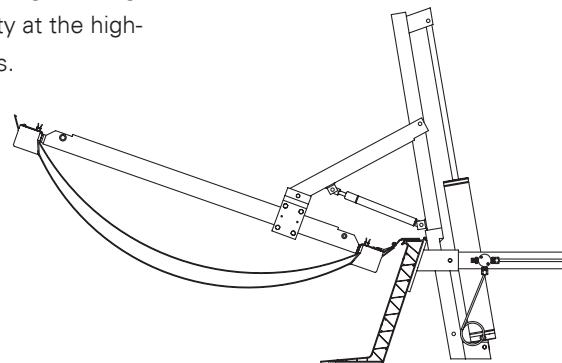

"The complete service range they provide, from the fast preparation of offers through qualified construction work right through to final acceptance, convinces me every time."

Graduate Engineer Walter Martini, Kemmler Industriebau, Tübingen

More daylight – more wellbeing.



The power is in the sun.

Skylight domes and arcade rooflights have been ESSMANN GmbH's main line of business for decades. The company became aware of the special significance of the optimized utilization of daylight at a very early stage. After all, wasn't it the philosopher and novelist Honoré de Balzac (1799–1850) who said "Light is a symbol of life and joy". And we are certain that Monsieur de Balzac meant natural light, which has to be captured and guided in the right direction.

Entire books can and have been written about the advantages of natural lighting, so here are the most important aspects in brief:

Natural daylight enhances people's wellbeing and satisfaction and has a positive effect on productivity at the same time. It is healthy, it reduces the risk of accidents, it conserves the environment and it doesn't cost anything. All of which means that it can be used extremely efficiently. And there is one further advantage, by the way: light that comes from above is up to five times brighter than light from the side.

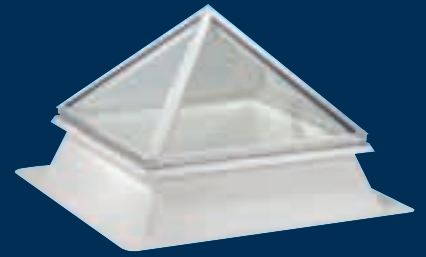

To utilize this bundle of advantages in the ideal manner requires perfected, resilient and durable technology. Flat roofs offer the ideal prerequisites for the mounting of skylight domes and arcade rooflights and permit optimum natural lighting, depending on how they are arranged. In addition to the technical aspect, people are becoming more and more aware of the aesthetic component, too. Round, rectangular or pyramid-shaped designs with many fittings versions offer plenty of creative leeway in architectural planning. From highly effective skylight domes to decorative pyramids made of glass and steel which become dominant features far into the distance.

A lot of emphasis is placed on functionality: ESSMANN often has been and still is a pioneer in the development of entry and exit systems, anti-vandalism devices, elements to provide shade and the latest personnel securing systems.

And last but not least, the technically highly developed and efficient ESSMANN daylight systems not only utilize all of the advantages of natural light, the money others spend on expensive artificial lighting can be saved too!



"...they think of everything and make our work easier. They produce the right results too."

Gerhard Vieregge, Vieregge Bedachungen, Allersberg

More air – more satisfaction.



The best air conditioning is none at all.

Light is one of the factors for more quality of life, air is the other and it is just as important. Fresh air produces a good climate at the workplace in all senses of the word.

Natural ventilation is based on a simple physical principle: warm, used air rises up and has to find its own way out. This is done by means of controllable, low-noise ventilation motors which can be adapted to suit all operating conditions. Even more comfort and efficiency can be achieved through additional electronic control units, particularly in multi-storey buildings or in places where increased demands are placed on air quality. Mechanical ventilation makes use of fans and a sophisticated, precisely calculated air intake system. Precise planning, calculation and layout are just as much a part of our service range as the monitoring of the air in the room at the customer's premises.

ESSMANN systems operate efficiently and reliably on and in many commercial and public buildings in strict compliance with all legal standards and regulations. And it makes no difference whether new construction, reconstruction or subsequent modernization work is involved.

A comprehensive analysis is made in the course of the first consultancy discussions to make sure that you get the system that suits your requirements. ESSMANN's team of experts accompanies you through every construction phase right through to commissioning – and beyond, of course.



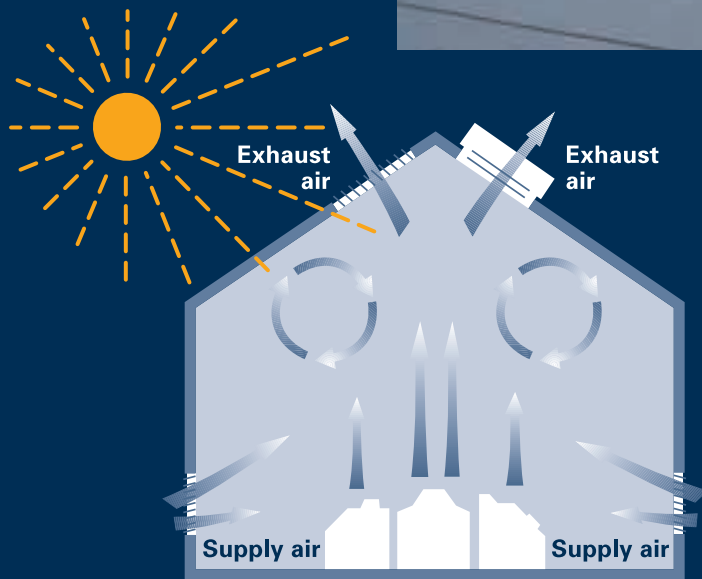

More protection – more safety.



Fire and smoke protection system.

Light, air and safety are the three essential elements which surround us every day of our working lives. The main task of the ESSMANN GROUP is to use these elements, draw advantages from them and constantly improve them.

Safety has absolute priority here, above all preventive fire protection, because every fire, no matter how small, causes damage to property, interruptions to the production process and a loss of image and customers which can often jeopardize the existence of the company. In the worst instances, personal damage and complete standstill of the production process can result.

The ESSMANN GROUP has involved itself for decades with an integrated fire and smoke protection concept, because the effects of smoke damage in particular are often underestimated. Apart from the damaging effects of smoke on sensitive electronic equipment and other valuable products, more than 80% of all fire victims die by suffocating on toxic smoke vapours rather than burns.

Natural and mechanical smoke and heat extraction systems, or RWA for short in German, extract the hot and toxic gases out of the building in the event of fire, thus assisting the rescue process and supporting the extinguishing measures undertaken by the fire service. The heat and smoke-extraction units can unfold their effects to the

ESSMANN
GROUP

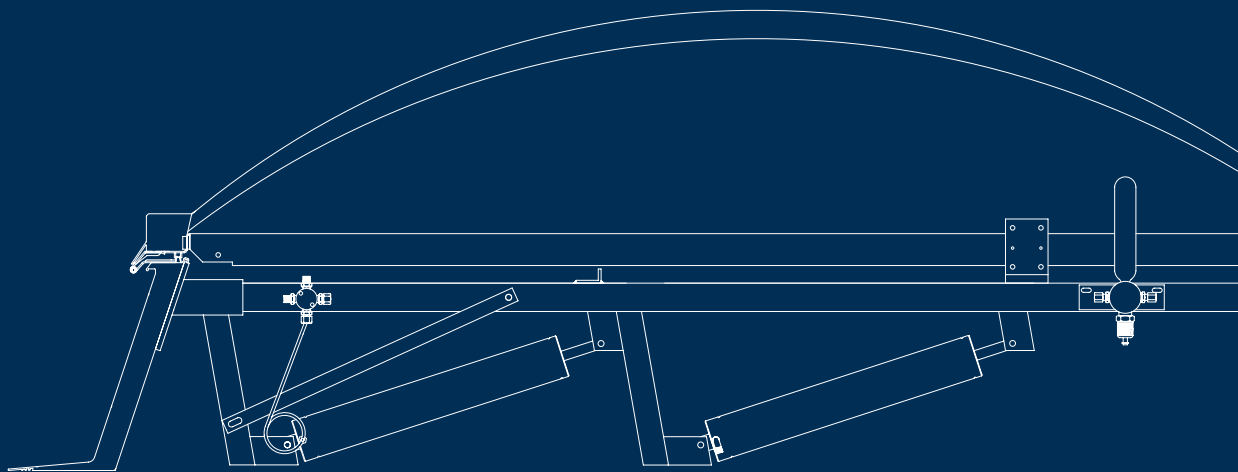

full, thanks to the controlled and specific supply of fresh air via the corresponding facade solutions. In this way, the accumulation of dense smoke in the lower levels of the room can be prevented, thus allowing any persons trapped by the fire to escape to safety.

What sounds so simple here is actually a highly complex and extremely effective system which requires a lot of expertise. Expertise that the ESSMANN GROUP has acquired from the combined know-how of ESSMANN, ECODIS, STG-BEIKIRCH, MSG, EURO SISTEMA INCENDIO (E.S.I.) and SEP Moravia.

The installation of smoke and heat extraction systems is subject to stringent regulations and legal provisions laid down in standards and building codes. In addition to this, there are several different installation options, depending on the type and architecture of the building.

Harmonizing these factors is the task of the ESSMANN GROUP. In close cooperation with the customer, our experts calculate and project a tailor-made concept which guarantees reliability and safety on the highest level.



“Smoke is a potential hazard. ESSMANN products offer individual smoke extraction solutions.”

*Graduate Engineer Werner Lorenz,
Engineering Office for Fire Protection and Construction, Holzminden*





More performance – more trust.

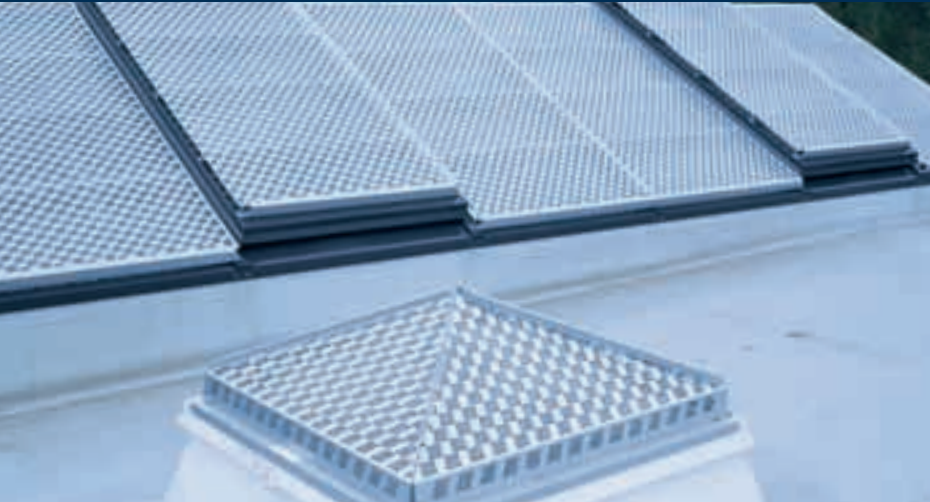

Experts and partners in all aspects of flat roofs.

Thanks to its closely knit network, the ESSMANN GROUP's field service is ideally equipped for many different tasks, such as modernization, for which there is an ever-increasing demand, the calculation of natural and mechanical smoke and heat extraction requirements and the efficient use of energy. The ESSMANN GROUP has many years of experience here, during which the necessary skills and abilities have been acquired. And they have also been the innovation leaders in the development of new technologies for decades!

Intensive cooperation with specialist roofing dealers is supplemented by the group's own logistics system, which ensures that roofers' businesses, for example, are supplied with the right materials without losing any time. The company's wide range of products for connection technology, which enables simple, safe and value-retaining sealing, is also a great help to roofers.

Despite all precautions and professional experience, working on roofs is still a dangerous job and ESSMANN has given top priority to personnel securing systems for a long time now. Special fall prevention consoles can be mounted directly onto the skylight domes and roof arcades the company produces. In addition to this, securing systems which prevent falls inside and outside of buildings serve as a collective safety measure. With these products, ESSMANN is acknowledging to the greatest possible extent the increasing importance of protective and securing devices for people working on flat roofs.

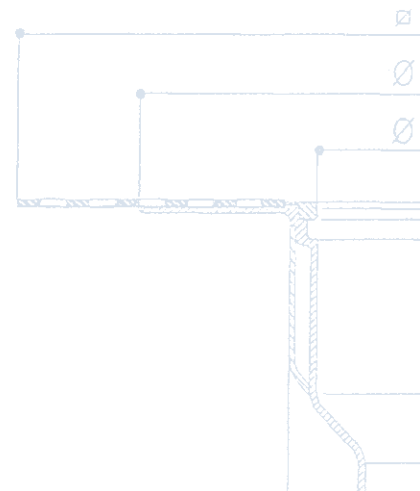

The ESSMANN range is rounded off by roof drainage systems which include a wide selection of roof gullies for many different connections. A location-specific capacity calculation prior to installation guarantees safe and effective utilization. The easy-to-install ESSMANN roof gullies can not only cope with large amounts of water, they are also decisive for the extended service life of a flat roof.



"A long partnership, experience, trust and fairness are very important, especially nowadays."

Anne Janssen, H. Janssen GmbH & Co. KG, Mönchengladbach

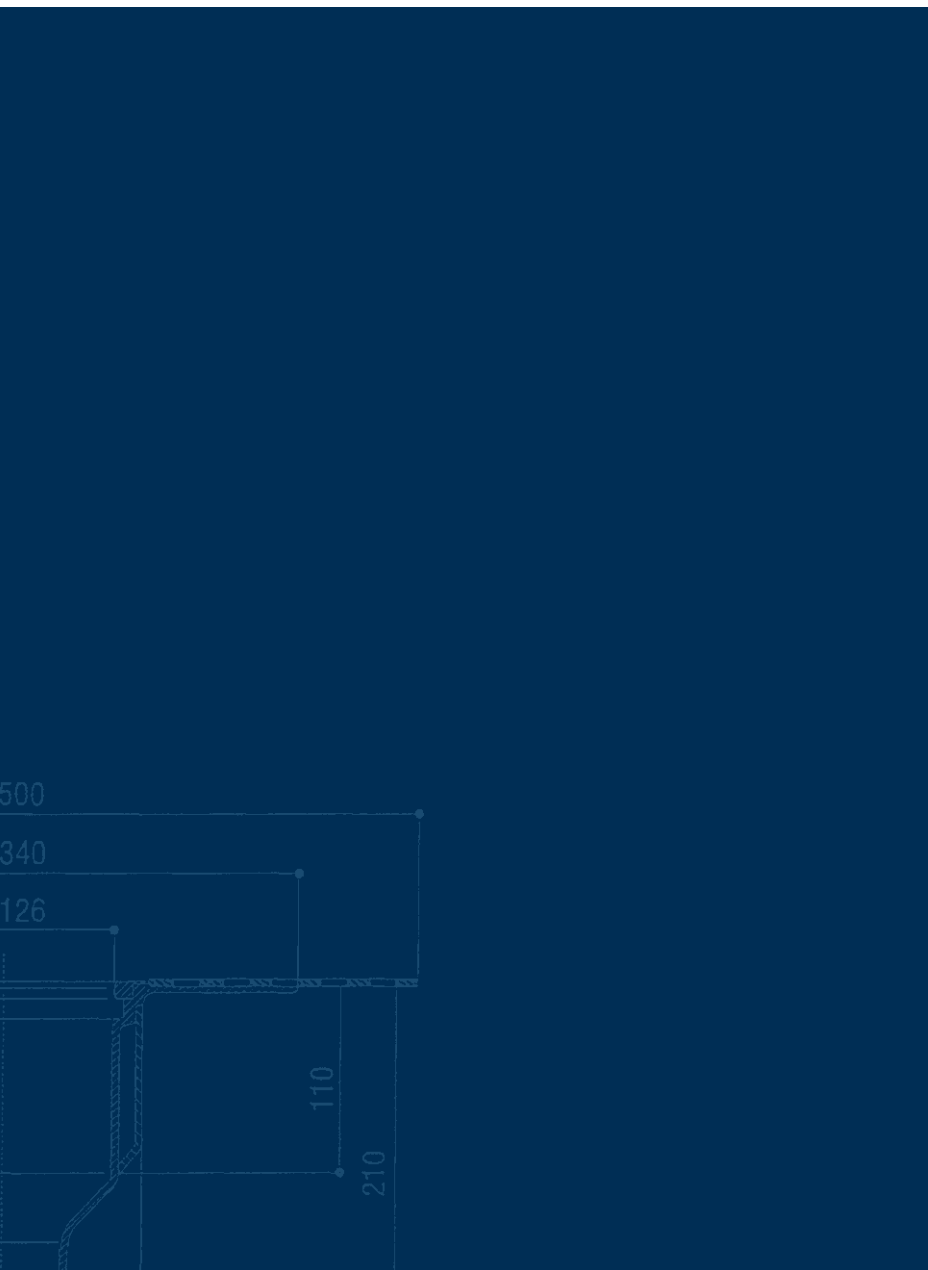

The people in the ESSMANN GROUP.



Capital and potential.

More than 800 people currently think and work within the ESSMANN GROUP. Although you won't have dealings with all of them, each and every one of them is there to help you. In production, administration and consulting. In research and development, quality assurance and logistics. Highly qualified, highly motivated and with a keenly developed team spirit. And with the knowledge that every customer is important to us.

This is why training is of such special importance to us and why we have committed ourselves to the intensive training of young people. Every year, many of these young people decide on a career within the ESSMANN GROUP in order to gain

qualifications in many different areas. They benefit here from the experience and knowledge of our staff members who have been with us for many years.

Internal, intensive and above all regular training for all of our employees is a matter of course for us, because it enables them to give you even better advice and pay even closer consideration to your needs.



Service in the ESSMANN GROUP.



We take care.

Every target group has its own specific demands on service and for this reason, each and every aspect of the services we offer is designed to deal with this in the ideal manner, because there is often a considerable difference between well-intended and well done. The professional logistics service provided within the ESSMANN GROUP gives ample evidence of our competence on a daily basis: the right part in the right place at the right time – within 24 hours if need be.

The range of technical services offered within the ESSMANN GROUP covers a wide area: the calculation of smoke and heat extraction systems and light and heating requirements is just as much a part of this as the complete documentation of all performances effected, which can save a lot of time and money at a later date. Another typical ESSMANN service: whenever necessary, our staff visit our customers – even during the construction phase – to provide whatever advice and know-how may be necessary.

With the ESSMANN GROUP's internet-supported communications system, another service medium with a high level of acceptance has been created which provides completely new opportunities for dialogue and cooperation.

And if something unforeseen happens, just get in touch with us. We will respond immediately and initiate all of the necessary measures. That's a promise.

Our internal and external seminars and training courses for our customers are also highly regarded by hundreds of participants, by the way. They deal with interesting topics in all relevant areas and we would be pleased to inform you about the extensive annual programme.

The future of the ESSMANN GROUP.



We are ready.

Not a day goes by without new findings, rules and regulations. Nor does a day go by without positive and – unfortunately – sometimes negative reports on the economic situation and developments.

The ESSMANN GROUP is looking ahead and facing up to the challenges of the future. Based on the success we have enjoyed in the past, there is only one way of thinking for us – positively – and we do this in all markets: regional, national and international. This includes the opening up of new markets in southern and eastern Europe, the consistent further development of our product spectrum and the expansion of our service range.

With the support of agencies right where you need them, we do not abandon you in foreign countries either, we accompany you with commitment all the way through your construction project.

Similarly, other important companies seek cooperation with the ESSMANN GROUP too. This offers a lot of scope for interesting tasks and projects and is also a token of regard for the work we have performed up to now.

Because we know that you can live well with a strong partner, we intend to continue with the expansion of skills and expertise within our group with the goal of constantly optimizing all of the services we offer and providing them from a single source.

Do you have any questions? If you do, please get in touch. We appreciate your interest in the ESSMANN GROUP.

ESSMANN
GROUP

An overview of the performance of the ESSMANN GROUP.

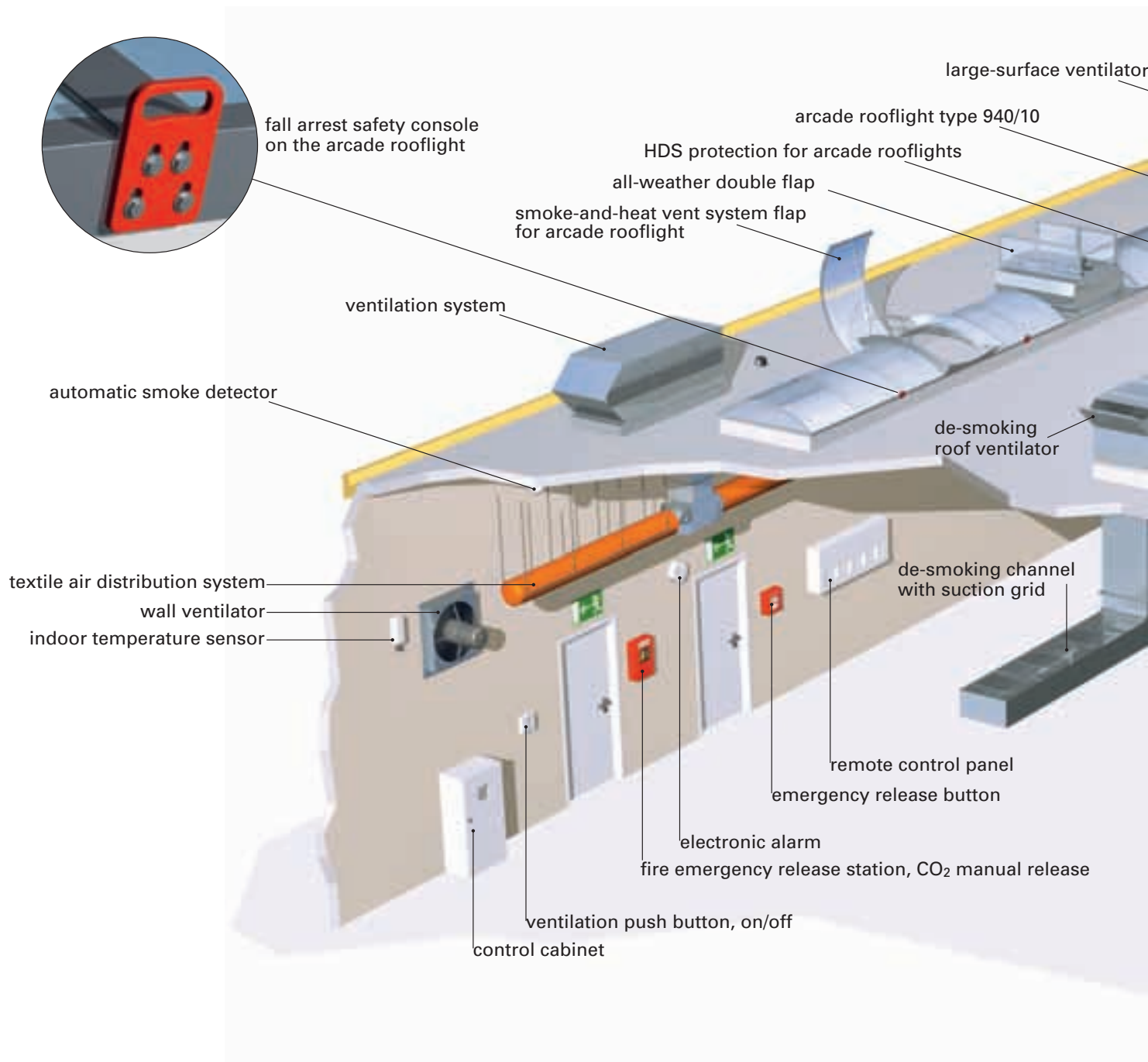

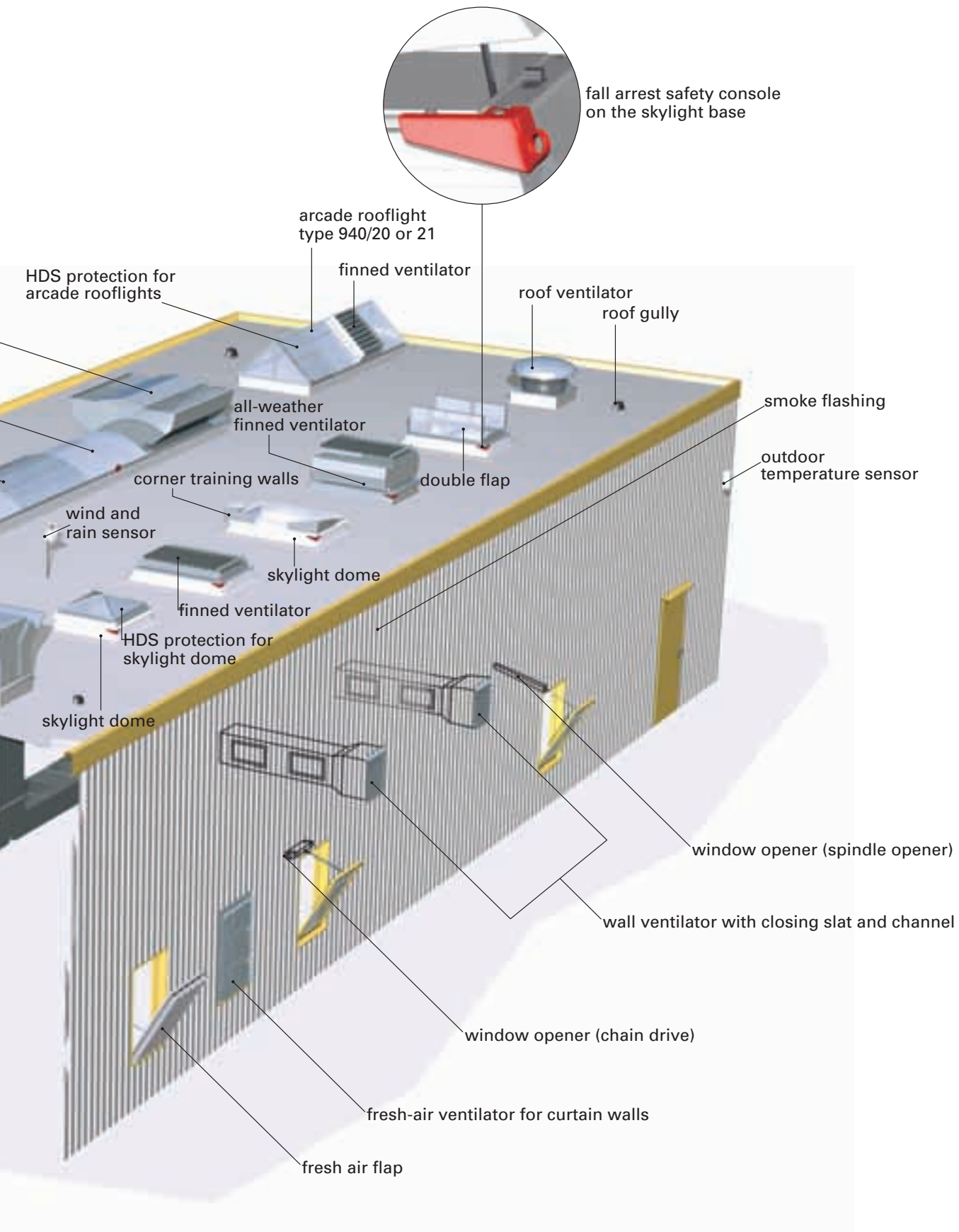

ESSMANN certification and test marks.



Certification is on hand for many different areas, from the products we manufacture to the company itself.



Product tests guarantee constant quality assurance and implementation in accordance with current regulations.



Membership in various associations ensures that we are always very well informed about the latest regulations and products.



A powerful group.

ESSMANN GmbH
 Im Weingarten 2
 D-32107 Bad Salzuflen
 Telephone +49(0)5222.791-0
 Telefax +49(0)5222.791-236
 E-Mail info@essmann.de
www.essmann.de

ESSMANN GmbH
 Subsidiary Frankfurt
 Kurhessenstraße 3
 D-64546 Moerfelden-Walldorf
 Telephone +49(0)6105.2090-0
 Telefax +49(0)6105.2090-20
 E-Mail nl-frankfurt@essmann.de
www.essmann.de

ESSMANN GmbH
 Subsidiary Augsburg
 Depotstraße 5 1/2
 D-86199 Augsburg
 Telephone +49(0)821.40805-0
 Telefax +49(0)821.40805-55
 E-Mail nl-augsburg@essmann.de
www.essmann.de

ESSMANN GmbH
 Subsidiary Hamburg
 Tonndorfer Hauptstraße 172
 D-22045 Hamburg
 Telephone +49(0)40.2393794-0
 Telefax +49(0)40.2393794-11
 E-Mail nl-hamburg@essmann.de
www.essmann.de

OOO ESSMANN
 Varshavskoe shosse 129, kor. 2, Office 508
 RUS-117545 Moscow
 Telefon +7 (495) 980-57-32
 Mobil +7 916 803 17 57
 E-Mail info@essmann.ru
www.essmann.ru

ESSMANN Polska Sp.z o.o.
 Stara Iwiczna ul. Nowa 23
 PL-05500 Piaseczno
 Telefon +48 22.7377041
 Telefax +48 22.7503310
 E-Mail info@essmann.com.pl
www.essmann.pl

ESSMANN Hungária Kft.
 Drava u. 5/a
 H-1133 Budapest
 Telefon +361.3297057
 Telefax +361.3597770
 E-Mail essmann@essmann.hu
www.essmann.hu

SEP Moravia s.r.o.
 Výstavní 3201
 CZ-70200 Ostrava - Moravská Ostrava
 Telefon +420 596 614 766
 Telefax +420 596 614 767
 E-Mail info@sepmoravia.cz
www.sepmoravia.cz

STG-BEIKIRCH
 Industrieelektronik + Sicherheits-
 technik GmbH & Co. KG
 Trifte 89
 D-32657 Lemgo-Lieme
 Telefon +49(0)5261.9658-87
 Telefax +49(0)5261.9658-66
 E-Mail info@STG-BEIKIRCH.de
www.STG-BEIKIRCH.de

ECODIS S.A.S
 Parc d'affaires de la vallée d'Ozon
 F-69970 Chaponnay
 Telefon +33(0)478.966900
 Telefax +33(0)478.966919
 E-Mail accueil@ecodis.fr
www.ecodis.fr

MSG Montage & Service fuer
 sicherheitstechnische Anlagen
 GmbH & Co. KG
 Ernst-Hilker-Straße 2
 D-32758 Detmold
 Telefon +49(0)5231.30801-0
 Telefax +49(0)5231.30801-551
 E-Mail info@msg-24.de
www.msg-24.de

EURO SISTEMA INCENDIO (E.S.I.) SLU
 J. Balmes, 62 1ªª
 Apdo. de correos 181
 E-08810 Sant Pere de Ribes (Barcelona)
 Telefon +34(0)93.896-15-76
 Telefax +34(0)93.896-15-77
 E-Mail eurosisistema@esi-sl.es
www.esi-sl.es

ESSMANN
 ▲ LIGHT ● AIR ■ SAFETY

**STG
 BEIKIRCH**
 Sicherheit auf
 höchstem Niveau

ECODIS

MSG
 Mehr Sicherheit gewinnen

**EURO
 SISTEMA
 INCENDIO**

**SEP
 MORAVIA**